

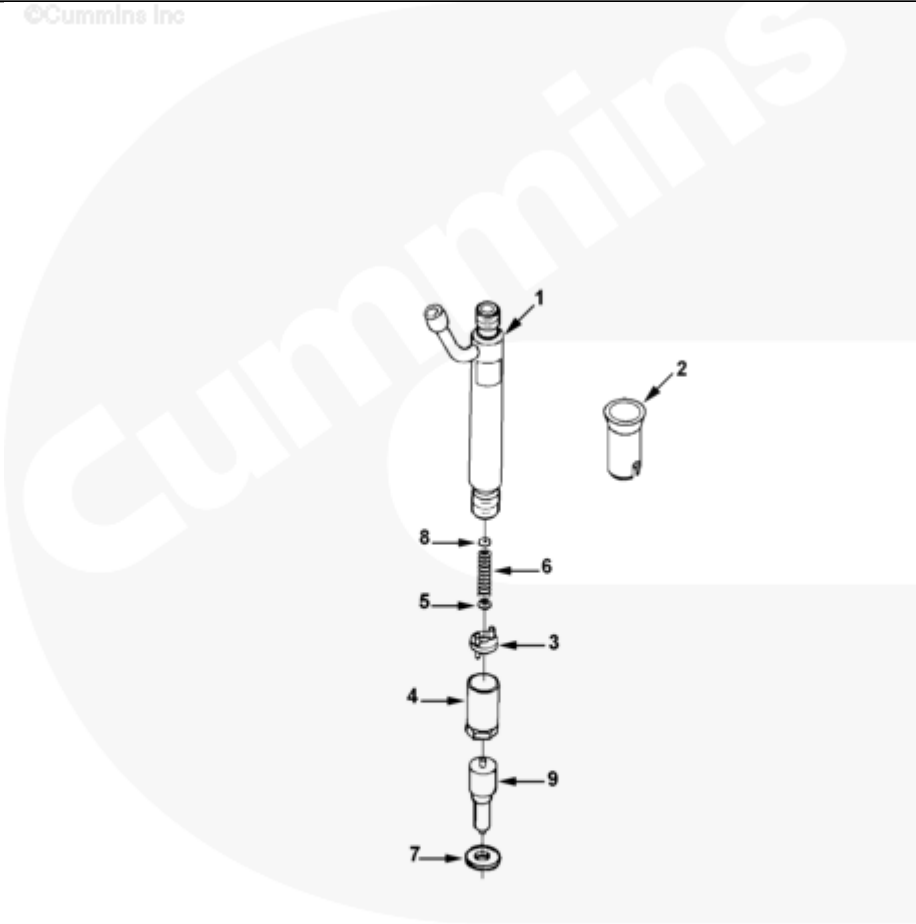

Parts Catalog - Option Detail

Electronic Parts Catalog - Option Detail				
Option	Group	Graphic	Film Card	Date
PP2105	06.01.1	fi940ga	Z	11-JAN-97
Engines	6C8.3, C GAS PLUS CM556, G8.3, G8.3 CM558, GTA8.3 CM558, ISC CM2150, ISC CM554, ISC CM850, ISC8.3 CM2250, ISC8.3 G CM2180 C101, ISL CM2150, ISL CM554, ISL CM850, ISL G CM2180, ISL8.9 CM2150 L110, ISL8.9 CM2880 L112, ISL9 CM2150 SN, ISL9 CM2250, ISL9 CM2350 L101, ISL9 CM2350 L111, ISLE4 CM850, L GAS PLUS CM556, L8.9, L8.9 L121, L8.9G CMOH2.0 L125B, L9 CM2350 L116B, L9 CM2350 L119B, L9 CM2350 L120C, L9 CM2350 L123B, L9.3 L105, L9.5 L117, L9N CM2380 L124B, QSC8.3 CM2250, QSC8.3 CM2880 C102, QSC8.3 CM554, QSC8.3 CM850(CM2850), QSL9 CM2250, QSL9 CM2250 L115, QSL9 CM2350 L102, QSL9 CM2350 L107, QSL9 CM2350 L118, QSL9 CM2350 L122, QSL9 CM554, QSL9 CM850(CM2850), QSL9 G CM558, QSL9 M CM2250 L106, QSL9.3 CM2880 L113			



fi940ga

SMALL | MEDIUM | LARGE

Cart	Ref No	Part Number	Part Description	Required	Remarks
View My Cart					
		PP2105	Fuel Injector		
					Performance Parts for:
					6CTA8.3 Litre
					Engine Family: C Series
					Reference CPL#: 2105
					Certified By: 'EPA', 'Taiwan
					EPA'
					Structure Code: 02 EBM
					Cylinders: 6
					Exh Mfld Type: Dry
					Aspiration: Charge Air
					Cooled
					Engine Certification Status:
					Approved
					Fuel Pump Model: Bosch P7100
					Certification Year: 1997
					High Pressure Fuel Line ID
					(mm): 1.8
					Catalytic Converter Required:
					No
					Cylinder Head Valve Material:
					Premium
					Base Turbocharger ID17:
					3532222
					3533005
					Piston part number 3924059,
					3924060 or
					3926301 may be substituted

					for 3922476 to achieve the
					correct piston height.
					Engines meet 1993 EPA
					standards.
<input type="checkbox"/>		3802644	Injector Kit	6	Recon Equivalent 3802644 RX
	1	3928384	Injector	1	Sold In Higher Level Assy/Kit
<input type="checkbox"/>	2	3909886	Injector Seal	1	
<input type="checkbox"/>	3	3905154	Intermediate Disc	1	
<input type="checkbox"/>	4	3905155	Injector Nozzle Retainer	1	
<input type="checkbox"/>	5	3915118	Injector Spindle	1	
<input type="checkbox"/>	6	3915119	Compression Spring	1	
<input type="checkbox"/>	7	3906659	Injector Seal	1	For 7mm Head
8					See Group 06.01.2
<input type="checkbox"/>	9	3928383	Injector Nozzle	1	